

Game – Setup Instructions

General game setup instructions.

Step 1:

Start with folded game laying on a flat surface, with the locking pin (A) facing up.

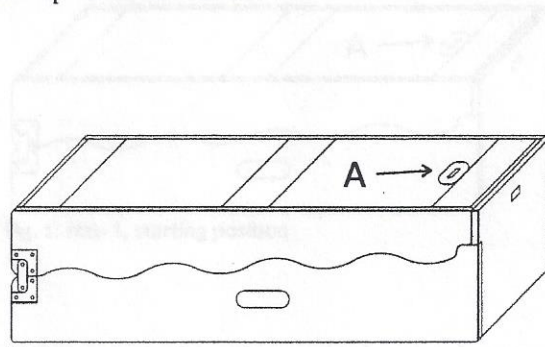

Fig. 1: step 1, starting position

Step 2:

Pull down on the pin (A) and lift the top side using the handles on either side of the pin. Unfold until the game both sides are resting on the floor or working surface.

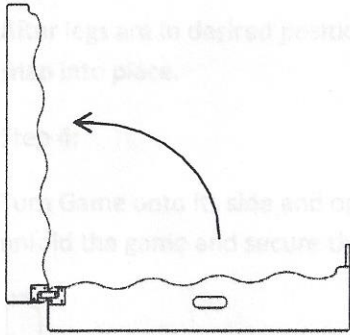

Fig. 2: step 2, Opening game